

<b>Legend</b> Building Ecological mitigation pond Balancing pond Replacement floodplain storage Woodland habitat creation Grassland habitat creation HS2 Hybrid Bill Woodland habitat creation HS2 Hybrid Bill Grassland habitat creation		Community forum boundary Watercourse diversion Existing watercourse Ditches - new Hedgerow habitat creation Main utility works Existing public right of way (PRoW)		New, diverted or realigned PRoW Stopped-up PRoW Rail alignment Noise fence barrier Chainage (e.g. 158M 10Ch)		<b>Map Number</b> <b>CT-06-052-TWAO</b> <b>Map Name</b> <b>Proposed Scheme</b> <b>TWAO - High Speed Rail (London - West Midlands) (Greatmoor Railway Sidings)</b>		 <small>HS2 Ltd accept no responsibility for any circumstances, which arise from the reproduction of this map after alteration, amendment or abbreviation or if it is issued in part or issued incomplete in any way.</small> <small>Registered in England. Registration number 08791688 Registered office: One Canada Square, London, E14 5AB</small> <small>© Crown copyright and database rights 2015. Ordnance Survey Licence Number 100049190.</small> <small>Doc Number: C222-ATK-EV-DPL-020-061299-TWAO P00.3 Date:</small>	
---	--	--	--	--	--	---	--	--	--

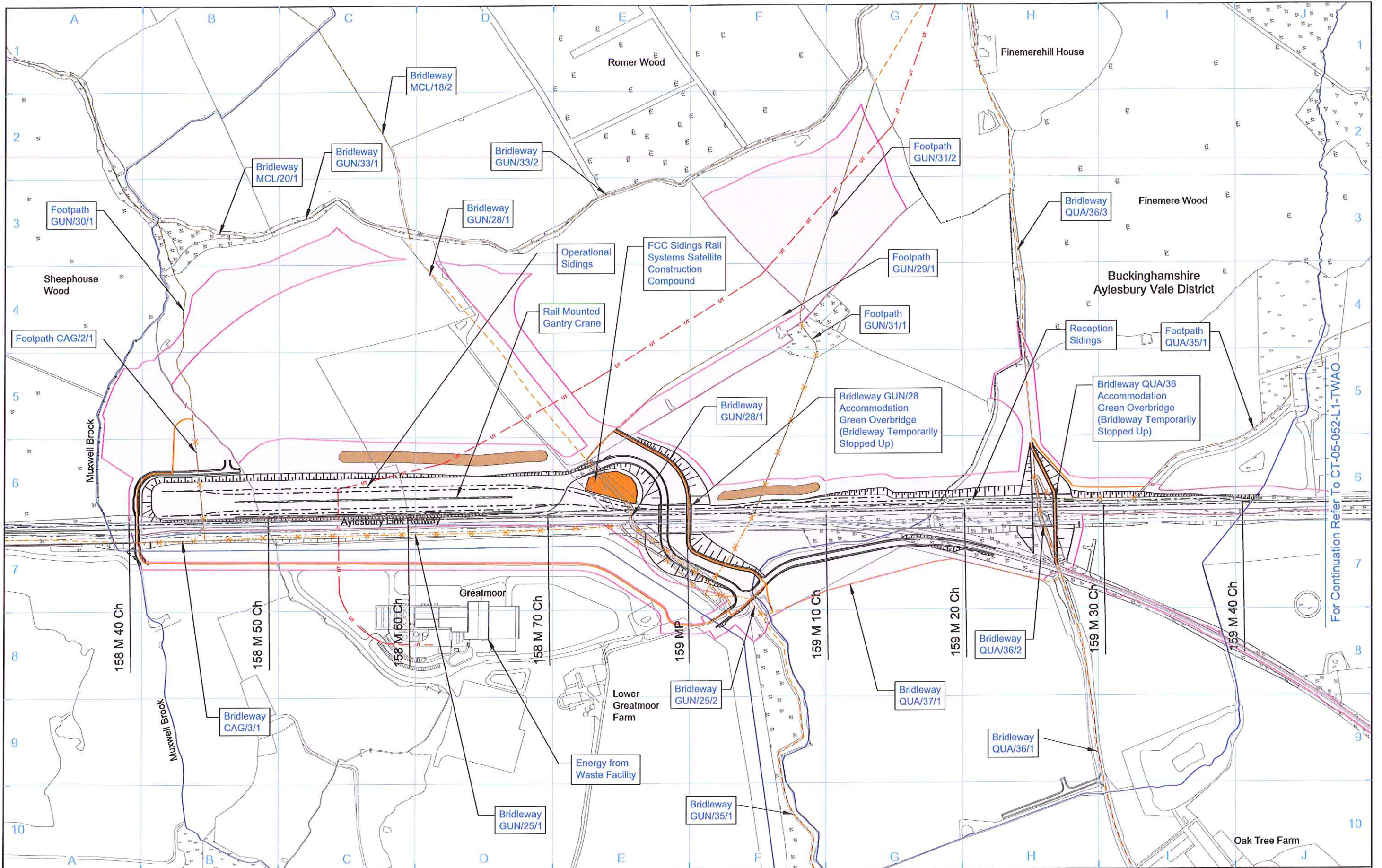



For Continuation Refer To CT-05-052-L1-TWAO

<b>Legend</b> Building Satellite construction compound Temporary material stockpile Engineering earthworks Land potentially required during construction Community forum boundary Existing watercourse Construction traffic route Existing public right of way (PRoW) New, diverted or realigned PRoW Stopped-up PRoW Temporary PRoW diversion / realignment Temporary highway diversion / realignment Main utility works Chainage (e.g. 158M 10Ch) Rail alignment			Map Number <b>CT-05-052-TWAO</b> Map Name <b>Construction Phase          TWAO - High Speed Rail (London - West Midlands) (Greatmoor Railway Sidings)</b>	 <small>HS2 Ltd accept no responsibility for any circumstances, which arise from the reproduction of this map after alteration, amendment or abbreviation or if it is issued in part or issued incomplete in any way.</small> <small>Registered in England. Registration number 06791668          Registered office: One Canada Square,          London, E14 5AS</small>  Scale at A3: 1:5,000 <small>0 50 100 150 200 250          Metres</small> <small>© Crown copyright and database rights 2015.          Ordnance Survey Licence Number 100049190.</small> Doc Number: C222-ATK-EV-DPL-020-051299-TWAO P00.3 Date:
--	--	--	---	---



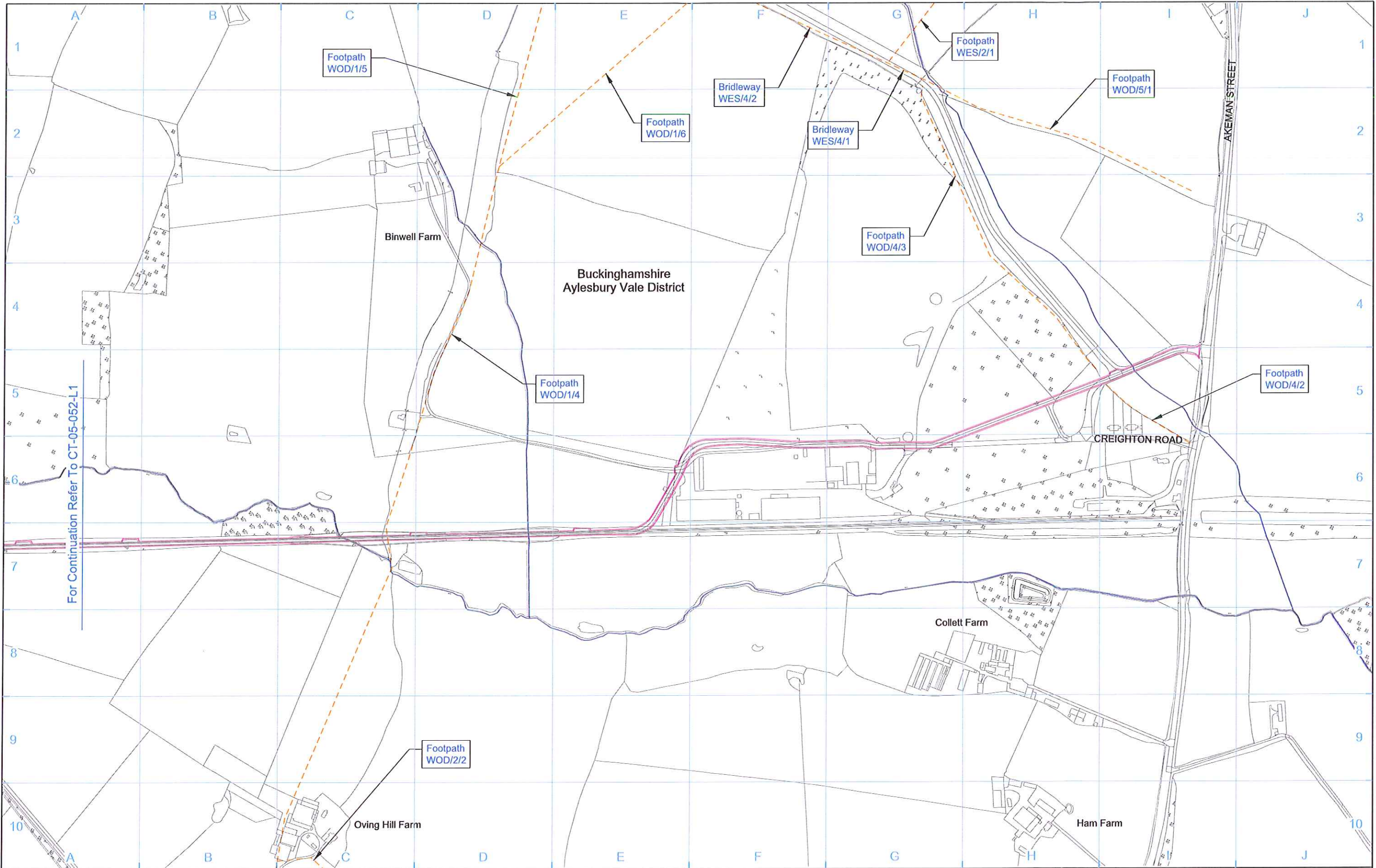

**Legend**

- |  |   |  |                                     |  |   |
|--|---|--|-------------------------------------|--|---|
|  | Building                                      |  | Community forum boundary            |  | Stopped-up PRoW                           |
|  | Satellite construction compound               |  | Existing watercourse                |  | Temporary PRoW diversion / realignment    |
|  | Temporary material stockpile                  |  | Construction traffic route          |  | Temporary highway diversion / realignment |
|  | Engineering earthworks                        |  | Existing public right of way (PRoW) |  | Main utility works                        |
|  | Land potentially required during construction |  | New, diverted or realigned PRoW     |  |   |

158M  
Chainage  
(e.g. 158M 10Ch)  
Rail alignment

Map Number  
**CT-05-052-L2-TWAO**  
Map Name  
**Construction Phase  
TWAO - High Speed Rail (London - West  
Midlands) (Greatmoor Railway Sidings)**

**hs2**  
Registered in England. Registration number 06791688  
Registered office: One Canada Square,  
London, E14 5AB

Scale at A3: 1:5,000  
0 50 100 150 200 250  
Metres

© Crown copyright and database rights 2015.  
Ordnance Survey Licence Number 100049190.

Doc Number: C222-ATK-EV-DPL-020-051297-TWAO P00.1 Date:



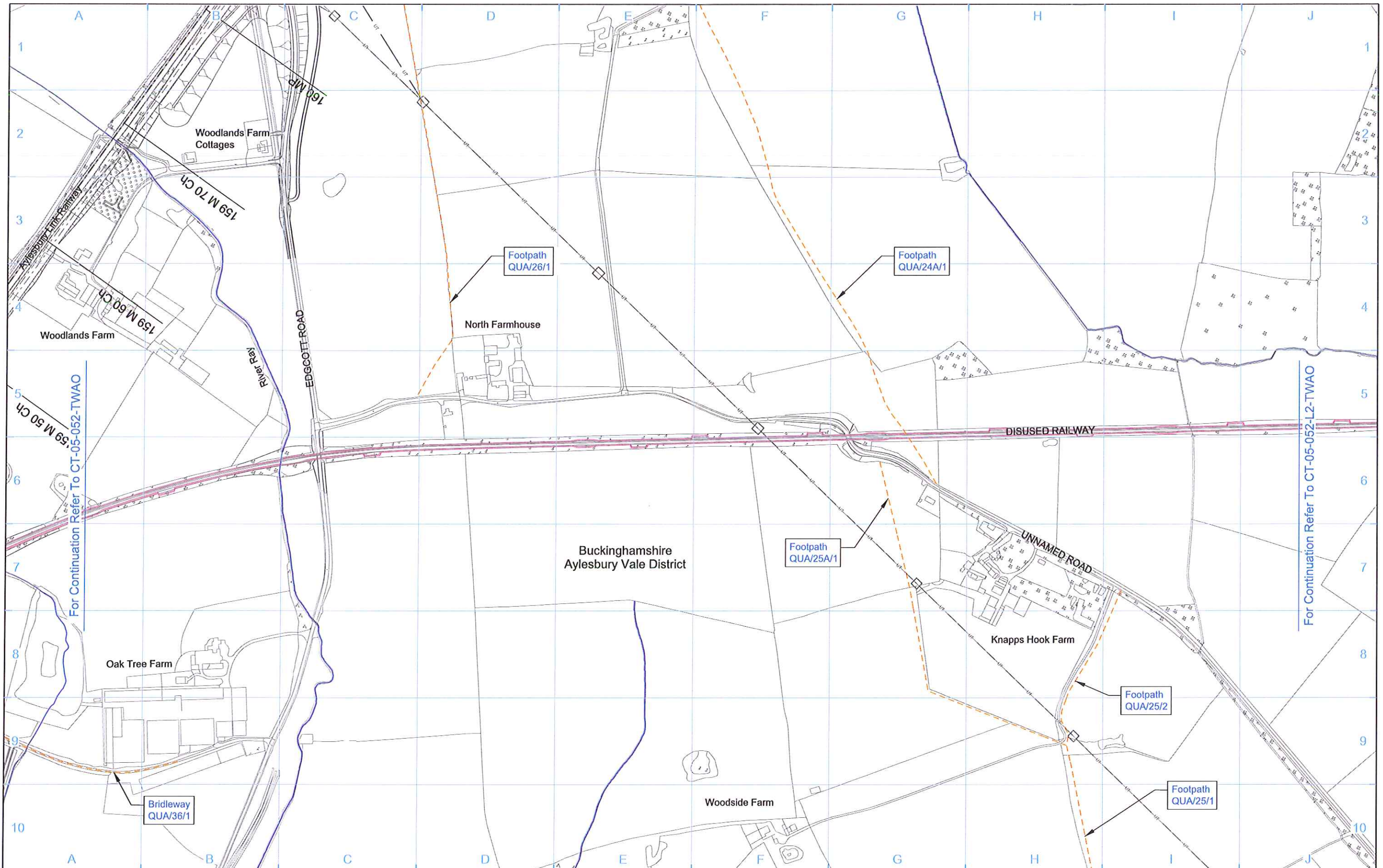

<b>Legend</b> Building Satellite construction compound Temporary material stockpile Engineering earthworks Land potentially required during construction		Community forum boundary Existing watercourse Construction traffic route Existing public right of way (PRoW) New, diverted or realigned PRoW		Stopped-up PRoW Temporary PRoW diversion / realignment Temporary highway diversion / realignment Main utility works		Chainage (e.g. 158M 10Ch) Rail alignment	
<b>Map Number</b> <b>CT-05-052-L1-TWAO</b>		<b>Map Name</b> <b>Construction Phase TWAO - High Speed Rail (London - West Midlands) (Greatmoor Railway Sidings)</b>				<small>HS2 Ltd accept no responsibility for any circumstances, which arise from the reproduction of this map after alteration, amendment or abbreviation or if it is issued in part or issued incomplete in any way.</small>	
<small>Registered in England. Registration number 06791688 Registered office: One Canada Square, London, E14 5AB</small>		<small>Scale at A3: 1:5,000</small>					
<small>© Crown copyright and database rights 2015. Ordnance Survey Licence Number 100049190.</small>		<small>Doc Number: C222-ATK-EV-DPL-020-051298-TWAO</small>		<small>P00.1 Date:</small>			